



Polyamide Cable Clamps



Our range of cable clamps are designed to hold and support a variety of different power cables in a variety of situations. The clamps are all short circuit tested and can clamp single or multiple cable arrangements.



The clamps are moulded from black polyamide 6GV and are suitable for use in temperatures from -40 to 120°C. They are resistant to oil, grease and both ozone and UV radiation. All clamps can accommodate individual cable loads up to 600 amp and can be supplied with the appropriate screws and fasteners.

M. Buttkereit Ltd.
Unit 2, Britannia Rd. Ind. Est.
Sale, Cheshire, M33 2AA

www.buttkereit.co.uk
info@buttkereit.co.uk
tel - 0161 969 5418, fax - 0161 969 5419



Single Cable Clamps

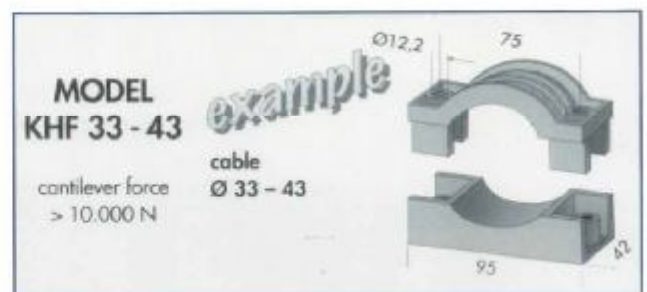
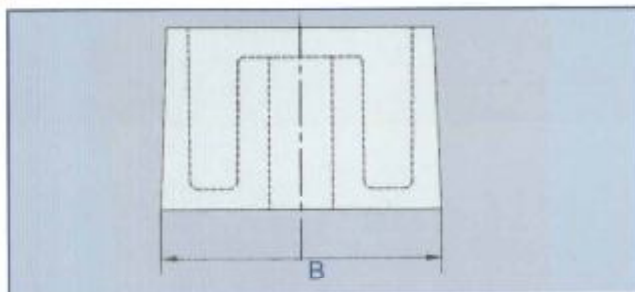
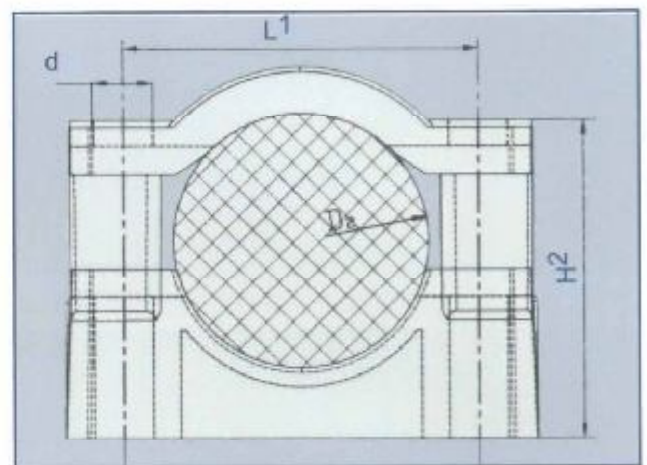
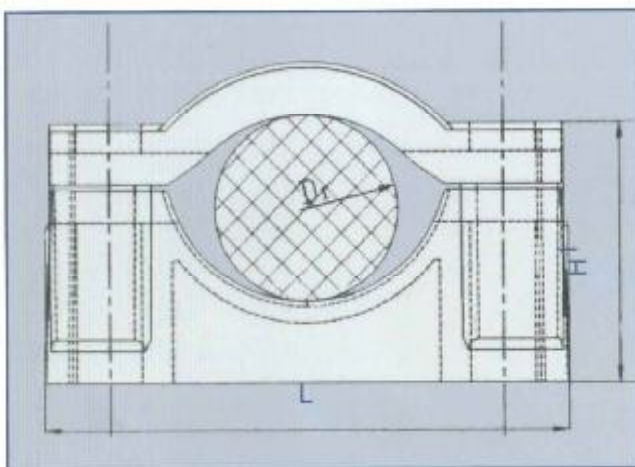

Model	Clamping Range for cable - mm	L mm	L ¹ mm	H ¹ mm	H ² mm	B mm	d mm	SL N
KHF 16-25 S	16 - 25	66	44	55	37	21	4.5	> 4500
KHF 16-25 B	16 - 25	66	52	44	35	32	7.0	>9000
KHF 24-38 S	24 - 38	66	52	50.5	36.5	32	7.0	>9000
KHF 24-38 B	24 - 38	95	75	54.0	41.0	55	11.4	>10000
KHF 33-43	33 - 43	95	75	43.0	34.0	42	11.0	>10000
KHF 35-54	35 - 54	100	75	67.5	48.5	55	12.5	>10000
KHF 45-55	45 - 55	95	75	52.0	42.0	42	10.5	>10000
KHF 50-76	50 - 76	116	95	74.0	48.0	52	12.5	>20000
KHF 70-92	70 - 92	148	120	105.0	127.0	72	15.0	>25000
KHF 90-100	90 - 100	182	150	127.0	147.0	80	15.0	>25000

SL - Short circuit resistance load

Multiple Cable Clamps



All cable clamps are manufactured from polyamide 6 GV. Polyamide 6GV is suitable for indoor and outdoor use from -40°C to 120°C . It is resistant to oil, grease ozone/UV radiation

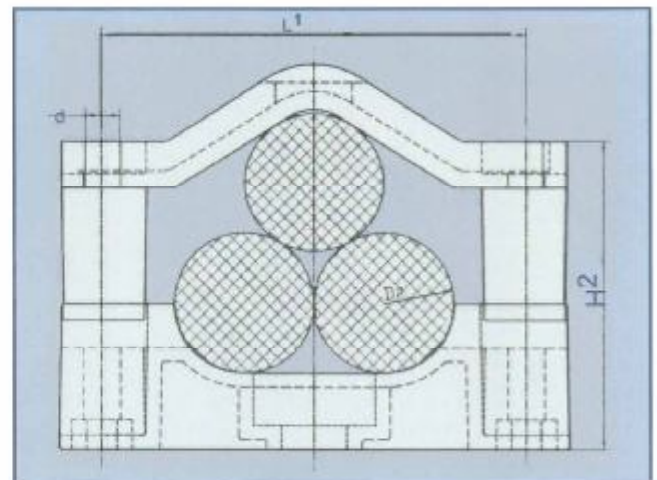
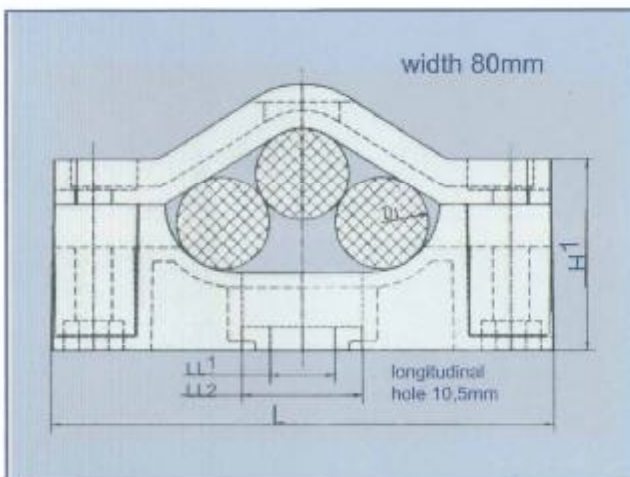

Model	Clamping Range for cable - mm	L mm	L ¹ mm	H ¹ mm	H ² mm	LL ¹ mm	LL ² mm	d mm	SL N
KHF/3 24-7	24-37	142	113.5	67	91	30	40	12.5	>25000
KHF/3 32-47	32-47	172	142.5	68	92	30	42	12.5	>25000
KHF/3 40-50	40-50	172	142.5	83	110	30	42	12.5	>25000
KHF/4 24-33	24-33	142	113.5	81	107	20	32	12.5	>25000

SL - Short circuit resistance load

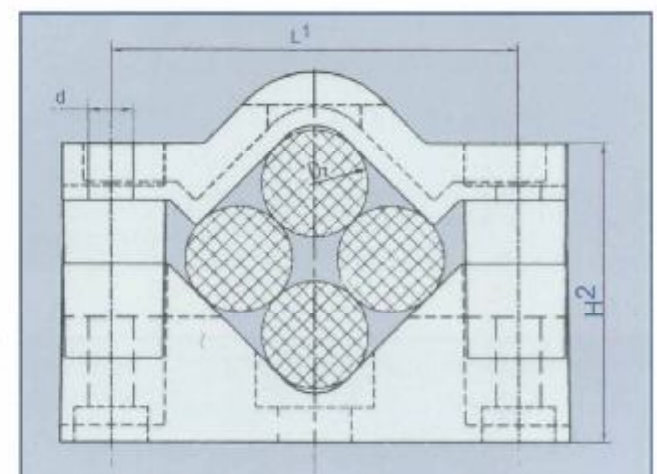
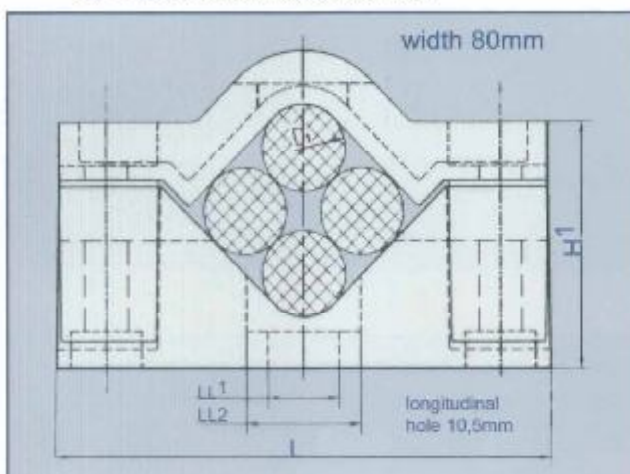



Multiple Cable Clamps

For insulated power cables in series or multiple layer combinations. Material: polyamide 6 GV black.

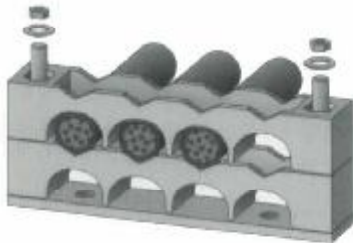

Polyamide 6GV is suitable for indoor and outdoor use from -40°C to 120°C. It is resistant to oil, grease ozone/UV radiation

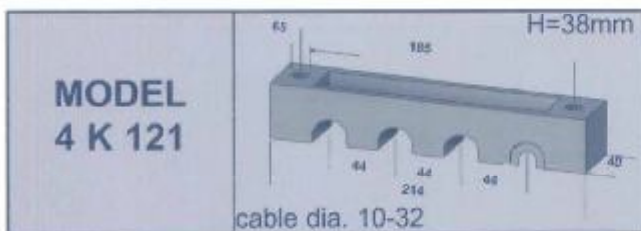
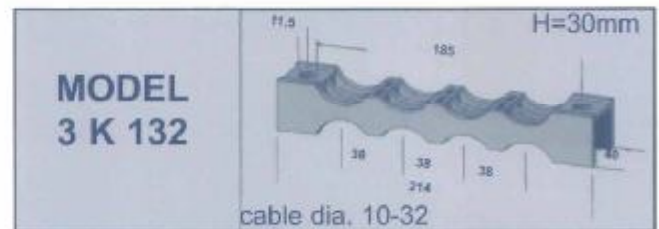
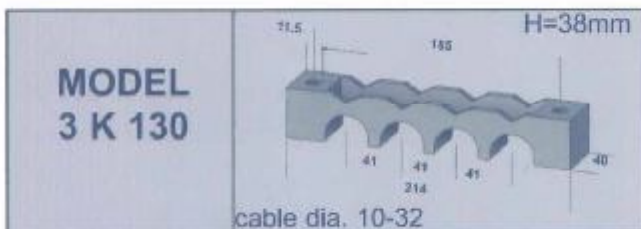
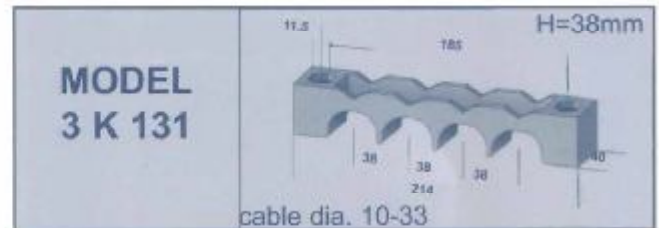
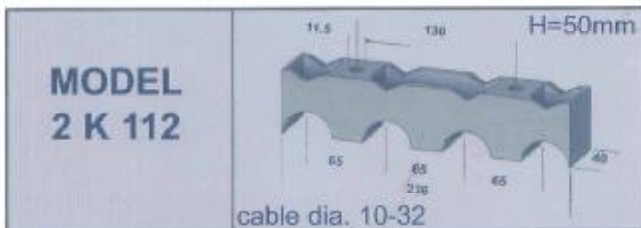

Mounting Example:

with 2 blocks for 3 to 4 cables
with 3 blocks for 6 to 8 cables
for exterior dia. 10-32 mm

mounting plate with stud bolts 6,8
M10 can also be supplied.

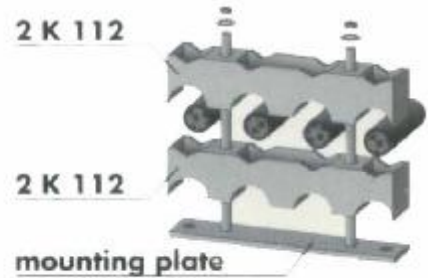
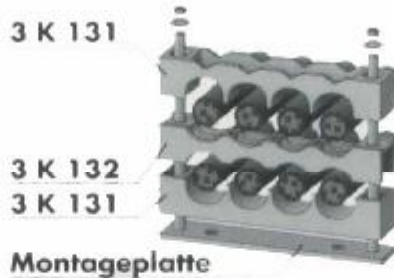

M. Buttkerreit Ltd.
Unit 2, Britannia Rd. Ind. Est.
Sale, Cheshire, M33 2AA

www.buttkerreit.co.uk
info@buttkereit.co.uk
tel - 0161 969 5418, fax - 0161 969 5419